



Liberty

## PRODUCT FEATURES

### *A narrower tub for a big bathing experience!*

A narrow 26" external dimension allows access into most bathrooms without major door modification, eliminating additional remodeling costs. Due to superior engineering, the interior bowl dimension is the largest among all 26 inch tubs.

A composite fiberglass bowl with a luxurious gelcoat surface over a welded steel frame produces a door opening impervious to twisting and warping. All Best Bath walk-in tubs offer a limited lifetime warranty.

The patented movable hinged seat is a feature that combines a recessed stepping area with a hinged seat plate creating an alcove to promote a comfortable (and much safer) ingress and egress to the tub.

The elegant, user-friendly patented door latch is constructed of stainless steel and brass components, no plastic. If adjustment should ever be necessary, it is easily made with this designer lever.

Jetted models feature the quietest whirlpool pump available, the new Syllent Pump. This pump is designed with a heat recycling feature to maintain water temperature and eliminate the need for an expensive in-line heater and additional wiring. This pump has a 10-year factory warranty.

Stainless steel cable operated tub drain mechanism with a lever handle for easy operation.

Pre-installed plumbing with quick connect lines for easy professional installation.

New heated seat with keypad control.

Deck extension and wall surround available.

Optional ozone sanitation system available.

[www.best-bath.com](http://www.best-bath.com)



# XTW5026 Liberty

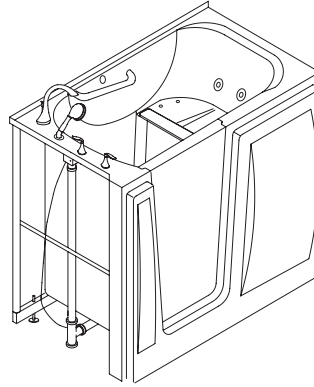
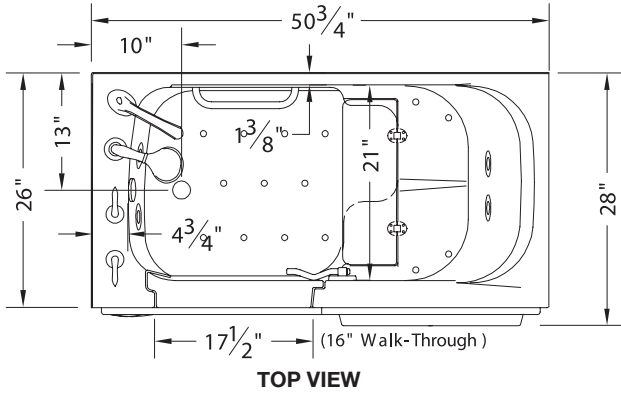

## FEATURES

- NEW heated seat with keypad control
- Designed to fit in the space of your current bathtub
- Swing up seat for easy entry
- Seat height is designed for ease of sitting and standing
- Extra deep for a full body soak
- Innovative patented door handle designed for easy operation
- Reliable door seal that comes with a lifetime warranty
- Allows you the freedom to rehabilitate at home
- Removable equipment access panel gives easy install through a 26" bathroom doorway
- Space under tub allows for "reverse" plumbing
- Optional Syllent brand jet pump: a revolutionary, ultra quiet design that helps maintain water temperature without an external heater, limiting the power requirements to just 15 Amps/110 Volt
- Optional (heated) Airjet system (15 Amps/110 Volt)

LIMITED  
*Lifetime*  
Walk-in Tub Warranty  
Made in America

BACKLIGHT ZONE



NEW Heated seat with keypad control



Lifetime warranty on door seal



New Syllent Pump, no-leak seals

## RECOMMENDED ACCESSORIES

(ACCESSORIES NOT NECESSARILY REPRESENTED IN DRAWING)

ITEM	MODEL NUMBER	CODES
Deck Extension	LIBEXT	<b>Designed and manufactured in compliance with the following standards and codes:</b> -I.A.P.M.O. / A.N.S.I. Z124.1.2-2005 Plastic Bathtubs and Showers -A.S.M.E. A112.19.15-2005 & CSA B45-02 (R08) Whirlpool Bathtubs with Pressure Sealed Doors -A.S.M.E. A112.19.7-2006 Hydromassage Bathtub Appliances -Underwriters Laboratories 1795 & CSA C22.2 No. 218.2-93 Hydromassage Bathtub Appliances
Moen Valve and Trim Kit	KMOEN1040	
Water Jet System	KWJWHUS	
Air Jet System	KAJCHUS	
Italian Glide Bar System	KACXISA1000	
White Weighted Curtain (78"x48")	KACXCURT3010	
L-Shaped Curtain Rod	KACXRDCRK5030	
Flange Trim Kit	KFTKTR3 (tub only) KXFTK125 (tub with walls)	
Thermostatic Mixing Valve	KLAWL1040	
See options page for all available configurations		





Escape

## PRODUCT FEATURES

### *A wonderful new bathing experience!*

The Escape walk-in tub features our unique uni-body construction – one seamless composite fiberglass bowl with a luxurious gelcoat surface. The apron, tub deck and bowl are seamless, producing maximum structural integrity.

Due to this superior strength and resistance to movement the door opening is impervious to twisting and warping. All Best Bath walk-in tubs offer a limited lifetime warranty.

Pre-installed plumbing with quick connect lines for professional installation.

The elegant, user-friendly patented door latch is constructed of stainless steel and brass components, no plastic. If adjustment should ever be necessary, it is easily made with this designer lever.

Jetted models feature the quietest whirlpool pump available, the new Syllent Pump. This pump is designed with a heat recycling feature to maintain water temperature and eliminate the need for an expensive in-line heater and additional wiring. This pump has a 10-year factory warranty.

Stainless steel cable operated tub drain mechanism with a lever handle for easy operation.

New heated seat with keypad control.

Optional deck extension and wall surround available to complete the installation.

Optional ozone sanitation system available.

# LTOW5030 Escape

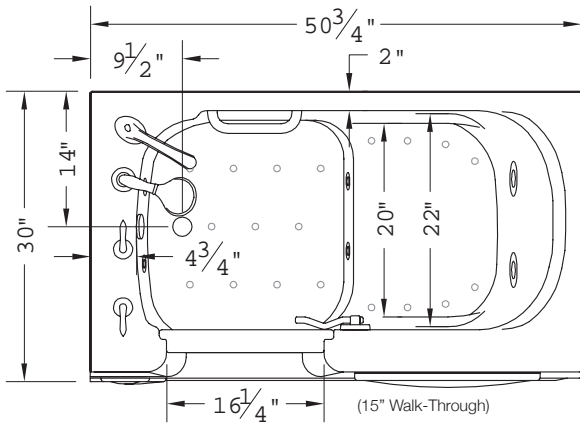

TOP VIEW

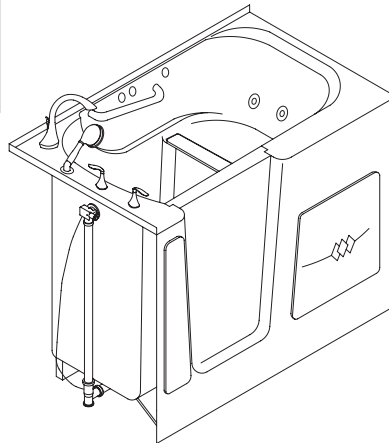

PERSPECTIVE VIEW

## FEATURES

- NEW heated seat with keypad control
- Designed to fit in the space of your current bathtub
- Seat height is designed for ease of sitting and standing
- Extra deep for a full body soak
- Innovative patented door handle designed for easy operation
- Reliable door seal that comes with a lifetime warranty
- Allows you the freedom to rehabilitate at home
- Space under tub allows for "reverse" plumbing
- Optional Syllent brand jet pump: a revolutionary, ultra quiet design that helps maintain water temperature without an external heater, limiting the power requirements to just 15 Amps/110 Volt
- Optional (heated) Airjet system (15 Amps/110 Volt)

LIMITED  
*Lifetime*  
Walk-in Tub Warranty  
Made in America

BACKLIGHT ZONE



NEW Heated seat with keypad control



Lifetime warranty on door seal



New Syllent Pump, no-leak seals

## RECOMMENDED ACCESSORIES

(ACCESSORIES NOT NECESSARILY REPRESENTED IN DRAWING)

ITEM	MODEL NUMBER	CODES
Deck Extension	ESC1000	<b>Designed and manufactured in compliance with the following standards and codes:</b> -I.A.P.M.O. / A.N.S.I. Z124.1.2-2005 Plastic Bathtubs and Showers -A.S.M.E. A112.19.15-2005 & CSA B45-02 (R08) Whirlpool Bathtubs with Pressure Sealed Doors -A.S.M.E. A112.19.7-2006 Hydromassage Bathtub Appliances -Underwriters Laboratories 1795 & CSA C22.2 No. 218.2-93 Hydromassage Bathtub Appliances
Moen Valve and Trim Kit	KMOEN1040	
Water Jet System	KWJWHUS	
Air Jet System	KAJCHUS	
Italian Glide Bar System	KACXISA1000	
White Weighted Curtain (78"x48")	KACXCURT3010	
L-Shaped Curtain Rod	KACXRODCRK5030	
Flange Trim Kit	KFTKTBE125 (tub only) KXFTK125 (tub and wall surround)	
Thermostatic Mixing Valve	KLAWL1040	

See options page for all available configurations





Escape Plus

P R O D U C T  
F E A T U R E S

*A bigger bathing experience!*

The Escape Plus has a larger door and deeper bowl than the Escape walk-in tub. It also features our unique uni-body construction – one seamless composite fiberglass bowl with a luxurious gelcoat surface. The apron, tub deck and bowl are seamless, producing maximum structural integrity.

The patented movable hinged seat is a feature that combines a recessed stepping area with a hinged seat plate creating an alcove to promote a comfortable (and much safer) ingress and egress to the tub. All Best Bath walk-in tubs offer a limited lifetime warranty.

Pre-installed plumbing with quick connect lines for professional installation.

The elegant, user-friendly patented door latch is constructed of stainless steel and brass components, no plastic. If adjustment should ever be necessary, it is easily made with this designer lever.

Jetted models feature the quietest whirlpool pump available, the new Syllent Pump. This pump is designed with a heat recycling feature to maintain water temperature and eliminate the need for an expensive in-line heater and additional wiring. This pump has a 10-year factory warranty.

Stainless steel cable operated tub drain mechanism with a lever handle for easy operation.

New heated seat with keypad control.

Optional deck extension and wall surround available to complete the installation.

Optional ozone sanitation system available.

# XTOW5030 Escape Plus

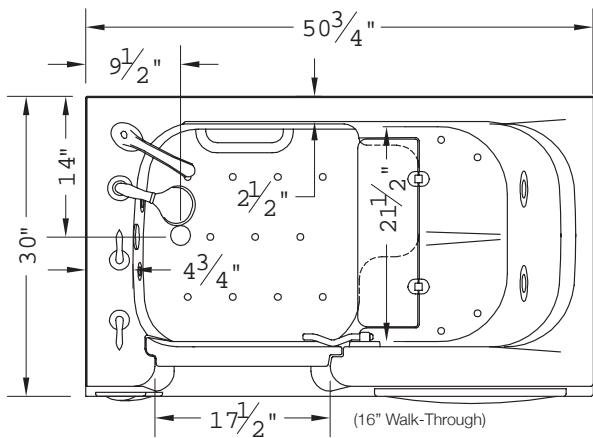

TOP VIEW

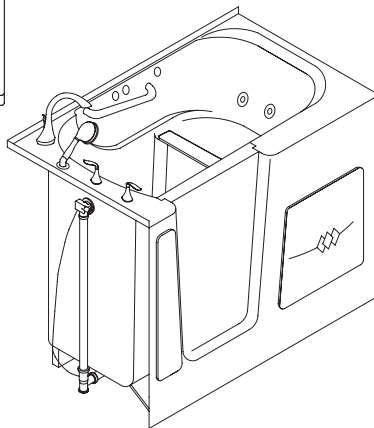

PERSPECTIVE VIEW

## FEATURES

- NEW heated seat with keypad control
- Designed to fit in the space of your current bathtub
- Swing up seat for easy entry
- Seat height is designed for ease of sitting and standing
- Extra deep for a full body soak
- Innovative patented door handle designed for easy operation
- Reliable door seal that comes with a lifetime warranty
- Allows you the freedom to rehabilitate at home
- Space under tub allows for "reverse" plumbing
- Optional Syllent brand jet pump: a revolutionary, ultra quiet design that helps maintain water temperature without an external heater, limiting the power requirements to just 15 Amps/110 Volt
- Optional (heated) Airjet system (15 Amps/110 Volt)

LIMITED  
*Lifetime*  
Walk-in Tub Warranty  
Made in America

BACKLIGHT ZONE



NEW Heated seat with keypad control



Lifetime warranty on door seal



New Syllent Pump, no-leak seals

## RECOMMENDED ACCESSORIES

(ACCESSORIES NOT NECESSARILY REPRESENTED IN DRAWING)

ITEM	MODEL NUMBER	CODES
Deck Extension	ESCX-1000	<b>Designed and manufactured in compliance with the following standards and codes:</b> -I.A.P.M.O. / A.N.S.I. Z124.1.2-2005 Plastic Bathtubs and Showers -A.S.M.E. A112.19.15-2005 & CSA B45-02 (R08) Whirlpool Bathtubs with Pressure Sealed Doors -A.S.M.E. A112.19.7-2006 Hydromassage Bathtub Appliances -Underwriters Laboratories 1795 & CSA C22.2 No. 218.2-93 Hydromassage Bathtub Appliances
Moen Valve and Trim Kit	KMOEN1040	
Water Jet System	KWJWHUS	
Air Jet System	KAJCHUS	
Italian Glide Bar System	KACXISA1000	
White Weighted Curtain (78"x48")	KACXCURT3010	
L-Shaped Curtain Rod	KACXRODCRK5030	
Flange Trim Kit	KFTKTBE125 (tub only) KXFTK125 (tub and wall surround)	
Thermostatic Mixing Valve	KLAWL1040	

See options page for all available configurations





Big E

## PRODUCT FEATURES

*The largest new walk-in bathing experience available!*

This new gigantic spa is over 45% wider than a standard walk-in tub.

The BigE features our largest door and bowl comprised of composite fiberglass with a luxurious gelcoat surface. The unit is secured to a welded steel base. A molded three sided skirt makes the unit impervious to twisting and warping. All Best Bath walk-in tubs offer a limited lifetime warranty.

The patented movable hinged seat is a feature that combines a recessed stepping area with a hinged seat plate creating an alcove to promote a comfortable (and much safer) ingress and egress to the tub.

Pre-installed plumbing with quick connect lines for professional installation.

The elegant, user-friendly patented door latch is constructed of stainless steel and brass components, no plastic. If adjustment should ever be necessary, it is easily made with this designer lever.

Jetted models feature the quietest whirlpool pump available, the new Syllent Pump. This pump is designed with a heat recycling feature to maintain water temperature and eliminate the need for an expensive in-line heater and additional wiring. This pump has a 10-year factory warranty.

Stainless steel cable operated tub drain mechanism with a lever handle for easy operation. The Big E also includes a second drain for faster water exit.

New heated seat with 30 minute timer for comfort during tub fill and drain times.

Optional ozone sanitation system available.

The concept and design of the BigE was inspired by bathing visionary Emmette Luter of Tylertown Mississippi.

# XTW6035 BIG E

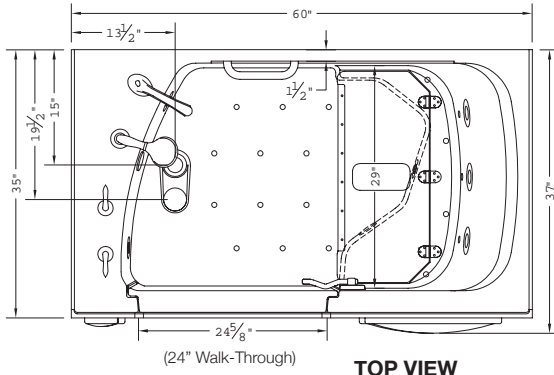

TOP VIEW

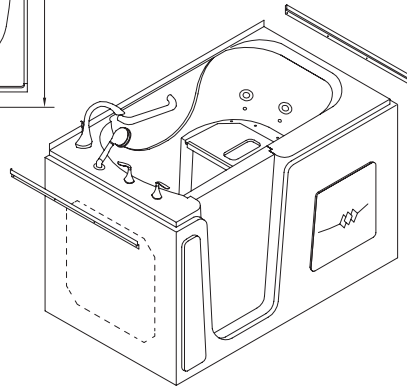

PERSPECTIVE VIEW

## FEATURES

- NEW heated seat with keypad control
- Swing up seat for easy entry
- Seat height is designed for ease of sitting and standing
- Extra deep for a full body soak
- Largest door opening available
- Innovative patented door handle designed for easy operation
- Reliable door seal that comes with a lifetime warranty
- Extra drain for faster exit
- Allows you the freedom to rehabilitate at home
- Installs in alcove, corner or along a wall
- Space under tub allows for "reverse" plumbing
- Optional Syllent brand jet pump: a revolutionary, ultra quiet design that helps maintain water temperature without an external heater, limiting the power requirements to just 15 Amps/110 Volt-Optional (heated) Airjet system (15 Amps/110 Volt)
- Optional Ozone sanitation system
- Optional open end panels for alcove and corner install

LIMITED  
*Lifetime*  
Walk-in Tub Warranty  
Made in America

BACKLIGHT ZONE



NEW Heated seat with keypad control



Lifetime warranty on door seal



New Syllent Pump, no-leak seals

## RECOMMENDED ACCESSORIES

(ACCESSORIES NOT NECESSARILY REPRESENTED IN DRAWING)

ITEM	MODEL NUMBER	CODES
Moen Valve and Trim Kit	KMOEN1040	<p>Designed and manufactured in compliance with the following standards and codes:</p> <ul style="list-style-type: none"> <li>-I.A.P.M.O. / A.N.S.I. Z124.1.2-2005 Plastic Bathtubs and Showers</li> <li>-A.S.M.E. A112.19.15-2005 &amp; CSA B45-02 (R08) Whirlpool Bathtubs with Pressure Sealed Doors</li> <li>-A.S.M.E. A112.19.7-2006 Hydromassage Bathtub Appliances</li> <li>-Underwriters Laboratories 1795 &amp; CSA C22.2 No. 218.2-93 Hydromassage Bathtub Appliances</li> </ul>
Water Jet System	KWJWHUS (white)	
Air Jet System	KAJCHUS	
Italian Glide Bar System	KACXISA1000	
White Weighted Curtain (100"x60")	KACXCURT0008	
L-Shaped Curtain Rod	KACXRODCRK6036	
Flange Trim Kit	KFTKTBE125 (tub only) KXFTK125 (tub and wall surround)	
Thermostatic Mixing Valve	KLAWL1040	

See options page for all available configurations





ADL Spa

P R O D U C T  
F E A T U R E S

*Independence, safety and comfort in a full-sized bath!*

The ADL Spa bathtubs are in a category of their own; you can stretch out your legs and relax in a full-size, deep soaker tub, immersing your back and shoulders in warm soothing water.

The patented sliding door won't get in the way of your legs and feet, and doesn't need extra clearance in front of the bath. Bathe in comfort and safety with all controls in easy reach. A hand shower is available so you can easily wash your hair.

Our Safety Plus System provides maximum water flow while maintaining a safe temperature to prevent scalding. Elevated, so you are always supported, and don't have to climb up and down. It's like getting in and out of bed.

Developed through the collaboration of two universities and several health organizations, the ADL Spa provides hydrotherapy baths for maximum health and circulation benefits.

Stay independent in your own home for less than the cost of three months in a care facility.

The ADL Spa is available in a variety of packages and upgrades and comes with a limited lifetime warranty.

# ADL Spa

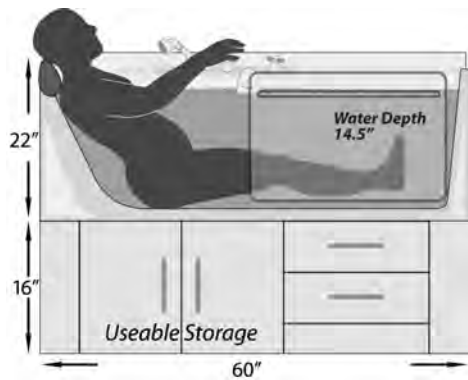

## STANDARD FEATURES

- Bathtub with unique sliding door and automatic safety latch
- White-finished cabinet fronts and drawers, with all hardware
- Right or left opening door choice
- Secondary drain in door track
- Access for easy connection to existing drain
- Contoured padded neck pillow in a variety of colors
- Four built-in grab bars for safety and easy movement
- Ergonomic deck-mount chrome drain control (drain handle not drilled, for flexible installation)

## UPGRADES INCLUDE

- 7-jet whirlpool system with massaging back, leg and foot jets and incredibly quiet operation
- Hygienic 20-jet air massage system with 3-speed heated jets
- Color and finish options for tub and cabinets
- Automatic ozone disinfection system (no chemical additives)
- Seatbelt and Harness system
- Ergonomic door-handle extension
- Safety Plus System features hi-flow thermostatic, anti-scald control valves
- Electronic touch pad control panel with digital temperature display

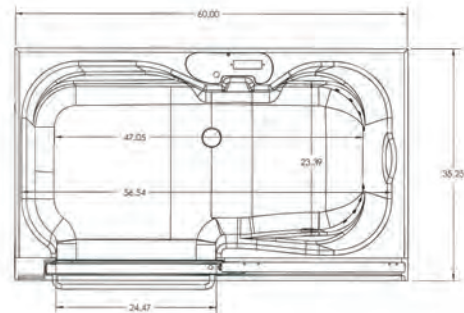

TOP VIEW

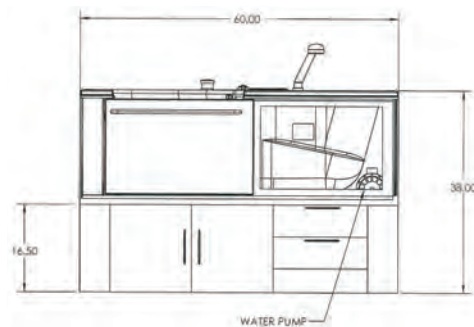

SIDE VIEW



New Syllent Pump, no-leak seals

## RECOMMENDED ACCESSORIES

ITEM	MODEL NUMBER
Hydrotherapy System	KWJ7CHADL
Air Massage System	KAJCHADL
Air & Water Jet System	KWAJCHASL
Ozone Automatic Disinfection System	ACXCGA1001
Door Extension Handle	ACXADL1104
Brushed Nickel - Safety Plus	KACXADL2000
Brushed Nickel - Touch Control	KACXADL2001
Cabinet Upgrade - Maple Veneer	ACXADL1114
Cabinet Upgrade - Oak Veneer	ACXADL1115
Cabinet Upgrade - Bamboo	ACXADL1116

LIMITED  
*Lifetime*  
Walk-in Tub Warranty  
Made in America

*Best Bath*  
SYSTEMS